

Valve Position Indication

Model: M-VIP-NPN

This Valve Position Switch comes complete with target puck and is designed to fit 1/4 turn namur actuators of all sizes. The housing is made from PBT Engineered resin and contains 2 x Normally Open (SPST) Contacts with a maximum switching capacity of 1.6A at 24V DC.

The M-VIP contains bi-colour LEDs for a secondary visual indicator to show when the actuator is in the open (green) and closed (red) position.



Properties

| | |
|--------------------------|---|
| Body Material | Engineered Resin |
| Connection Type | PVC Cable - 4 Core (Supplied with 2 metres) |
| Contacts/Output | 2 x Normally Open/SPST, NPN |
| Contact Material | Rhodium (Tungsten Optional) |
| Dimensions | 50 x 45 x 25mm |
| Visual Indicator | Rotating Puck, Bi-Colour LED's for Open/Closed Indication |
| Environmental Protection | IP 66, 67, 68 |
| Operating Temperature | -20°C to +80°C |

Ratings

| Supply Voltage | Maximum Switching Current | Maximum Voltage | Maximum Switching Power |
|----------------|---------------------------|-----------------|-------------------------|
| 10-30 VDC | 1.6A | 30 VDC | 40W VA |

Dimensions

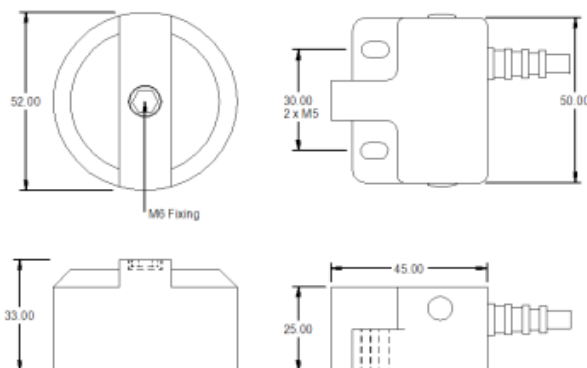

Connections

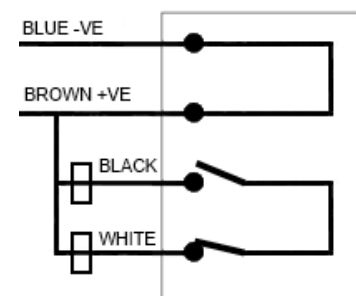

Certifications and Approvals

| Certification | Compliance | Certificate No. |
|-----------------|------------|-----------------|
| General Purpose | n/a | n/a |